

PAD FOR LEASE

Flamingo Promenade
NEC Flamingo & Hualapai

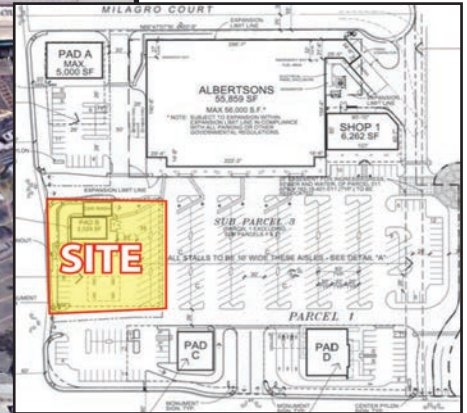

Highlights:

- Pad available for ground lease in grocery anchored center
- +/- .76 acres that can accommodate a maximum of 5200sf building
- Zoned C-2
- Pad rough graded with curb, gutter, landscaping and utilities to site
- South Summerlin still growing!
- Grocery, Rx and alcohol for off premises consumption will be restricted

Lisa J. Callahan, CCIM
lcallahan@sagelv.com
702.588.5254
License # B.0052504.IIC

Rhonda L. White
rwhite@sagelv.com
702.588.5255
License # S.0046288



sage

COMMERCIAL
ADVISORS

8708 Spanish Ridge Ave, Suite 150
Las Vegas, NV 89148
Ph: 702.588.5252
www.sagelv.com

* The information contained herein has been obtained from sources believed reliable. While we do not doubt its accuracy, we have not verified it and make no guarantee, warranty or representation about it. It is your responsibility to independently confirm its accuracy and completeness.

PAD FOR LEASE

Flamingo Promenade
NEC Flamingo & Hualapai



FOR MORE
INFORMATION CONTACT:

Lisa J. Callahan, CCIM
lcallahan@sagelv.com
702.588.5254
License # B.0052504.IIC

Rhonda L. White
rwhite@sagelv.com
702.588.5255
License # S.0046288



8708 Spanish Ridge Ave.
Suite 150
Las Vegas, NV 89148
Ph: 702.588.5252
www.sagelv.com

Demographics

	1 mile	3 mile	5 mile
2020 Est. Population	17,551	150,522	303,550
2020 Est. Median HH Income	\$69,667	\$68,379	\$68,373